

# Infra Rack

## Installation Guide

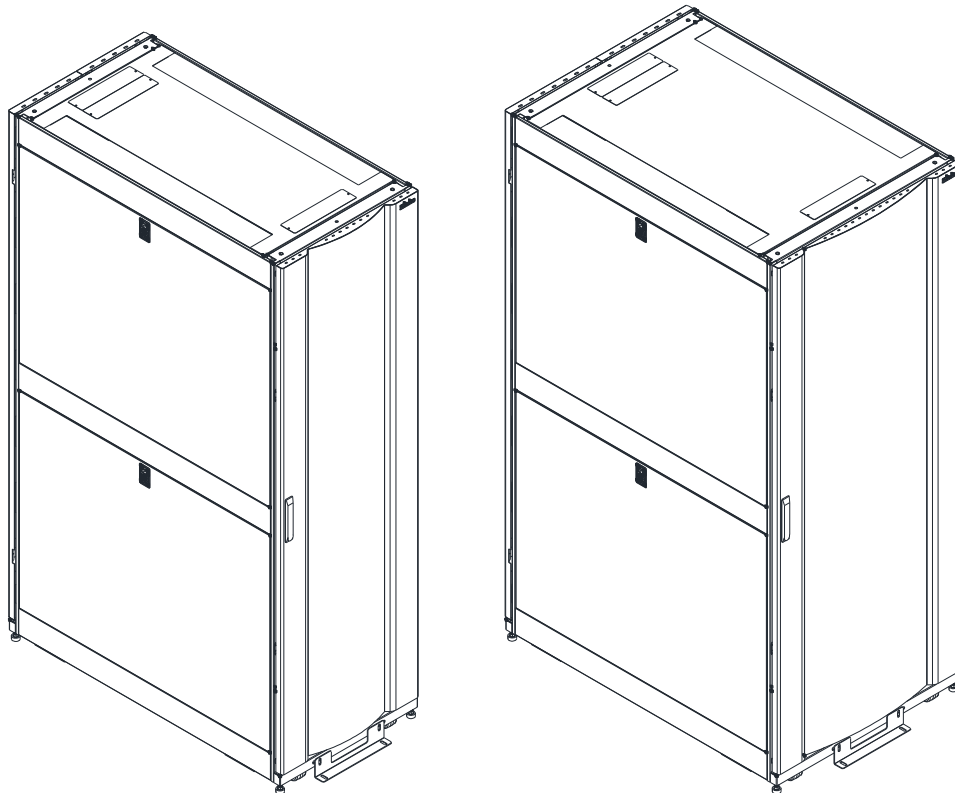

## Component Identification

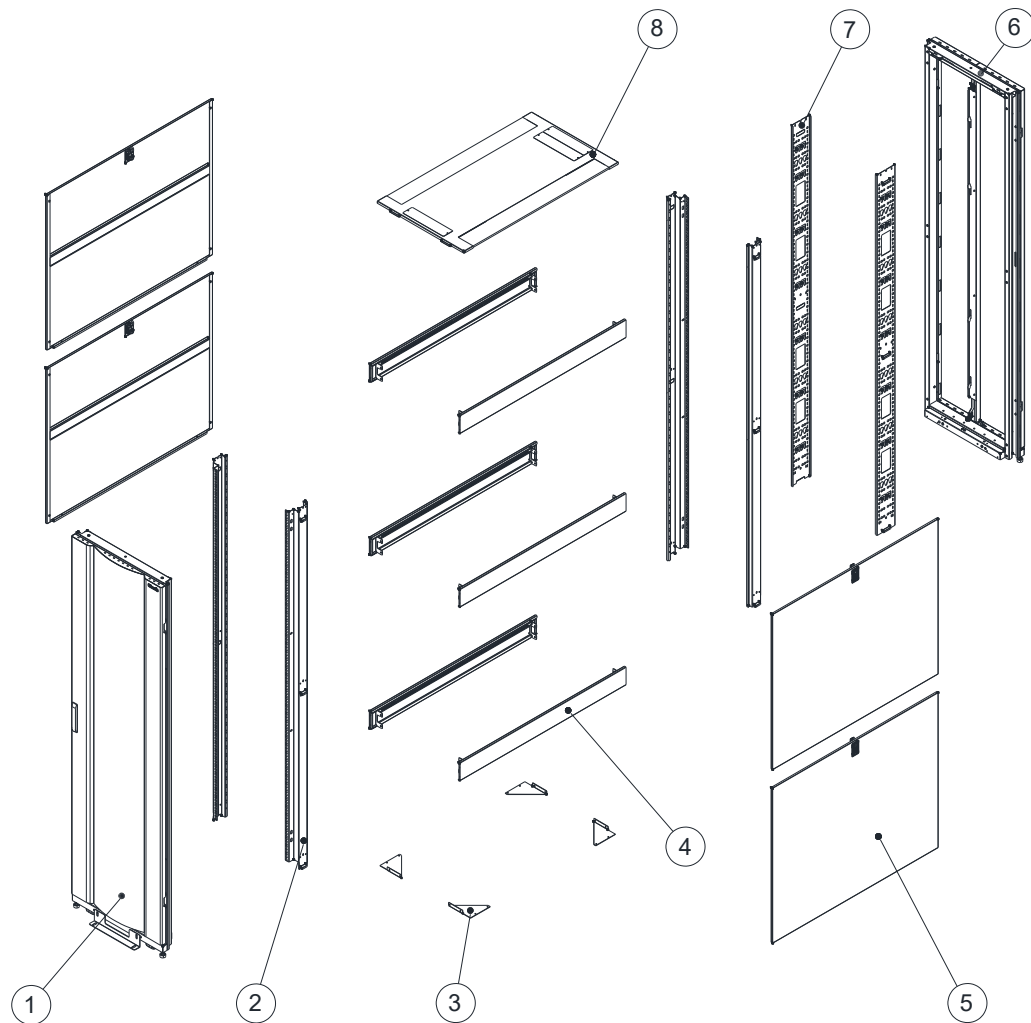

Item	Description	QTY.
<b>1</b>	Single Curved Mesh Front Door with Three-Point Locking System (with frame)	1
<b>2</b>	Mounting Rail Kit, 4 pcs	1
<b>3</b>	Corner Bracket	4
<b>4</b>	Horizontal Beam	6
<b>5</b>	Solid Side Panel Kit, 4 pcs	1
<b>6</b>	Flat Mesh Rear Door with Six-point Locking System (with frame)	1
<b>7</b>	PDU Bracket	2
<b>8</b>	Top Panel with Brushes	1

## Preparation



Electric screwdriver



PH2 Phillips screwdriver bit



T25&30 Torx screwdriver bit

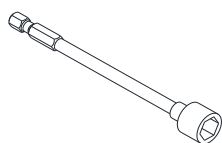

Hexagonal socket bit

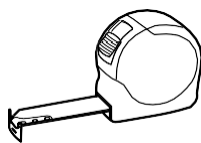

Tape measure

## Assemble The Rack

### Frame

#### ⚠ WARNING

##### **TIP HAZARD**

- Failure to properly support the frame during installation may result in **Serious Injury, Death, or Equipment Damage.**

- Connect corner brackets to the lower horizontal beams. Repeat the same operation twice.

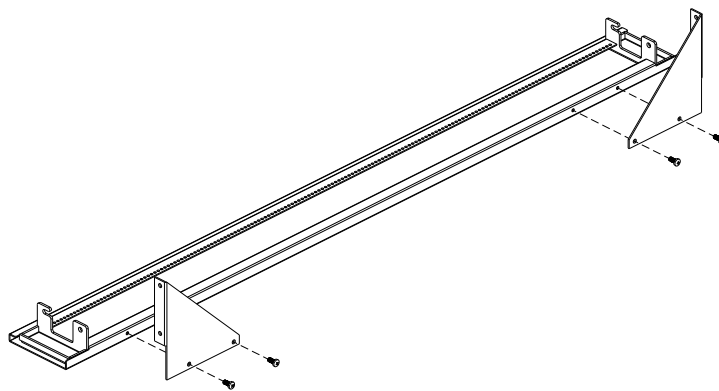

M5X10 Pan Head Torx Self  
Tapping Screws – 8 PCS

- Connect Beams and Frame.

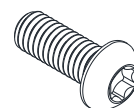
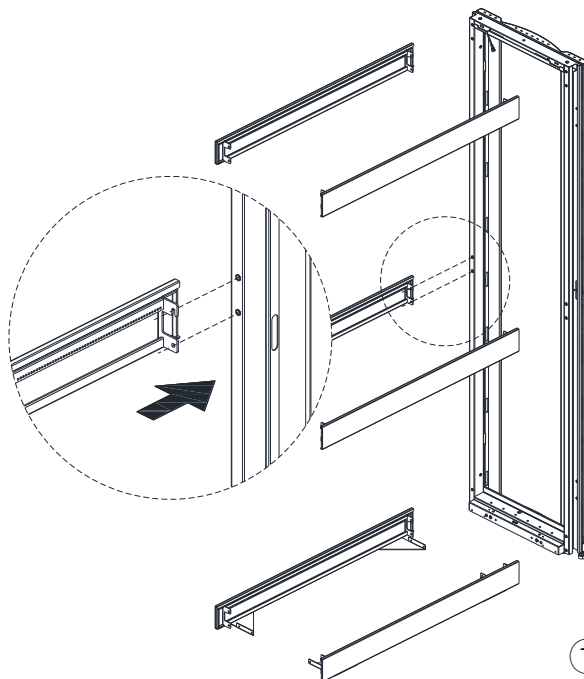

M6X16 Button Head  
Torx Screws – 24 PCS

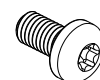

M5X10 Pan Head Torx Self  
Tapping Screws – 8 PCS

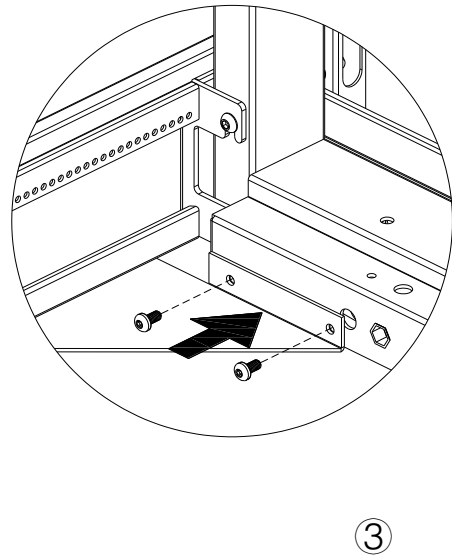
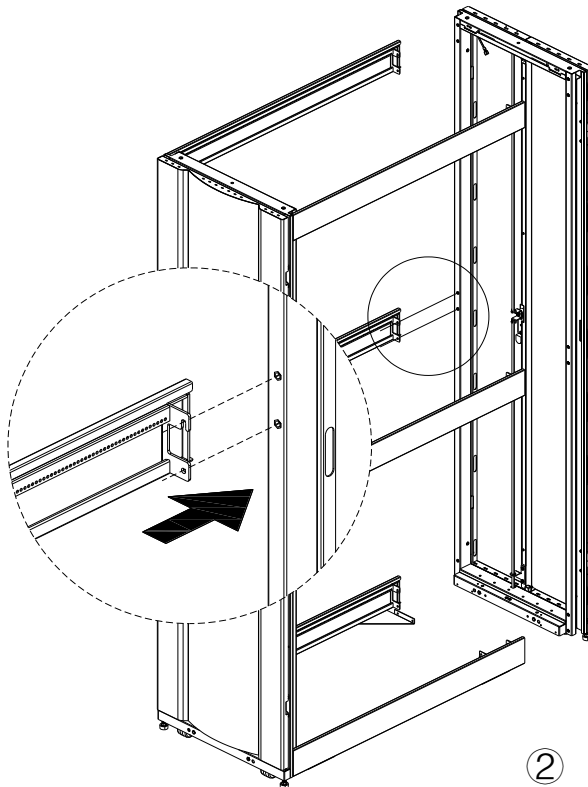

### **PDU BRACKET**

- Position one PDU bracket on each side of the rack frame.
- Hang the brackets onto the horizontal beams.
- Align the reference holes on both sides so that the mounting positions are identical.
- Secure the brackets using M4×8 self-tapping screws.

**Note:** The PDU brackets are typically installed near the rear door.



M4X8 Phillips Pan Head Self  
Tapping Screws – 12 PCS

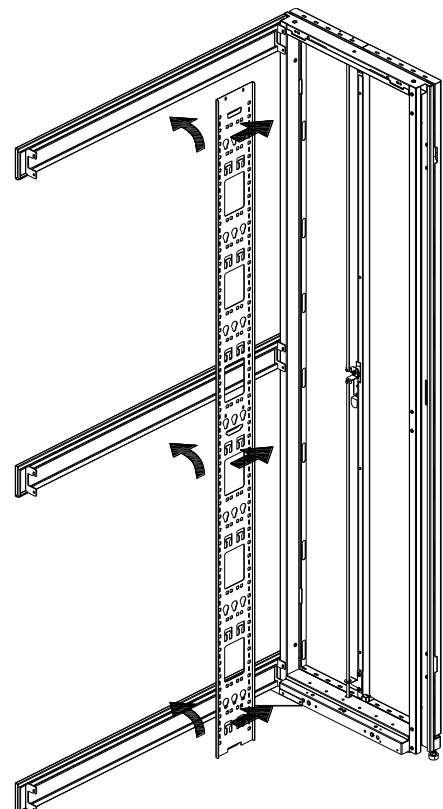

## **MOUNTING RAIL**

- Fix the mounting rails to the beams, two rails for each side.
- Align the reference holes on both sides so that the mounting positions are identical. (Otherwise, equipment installation will not be possible.)
- After installation, the distance between the front and rear mounting rails will be 29.5 in (750 mm).



M4X8 Phillips Pan Head Self  
Tapping Screws – 24 PCS

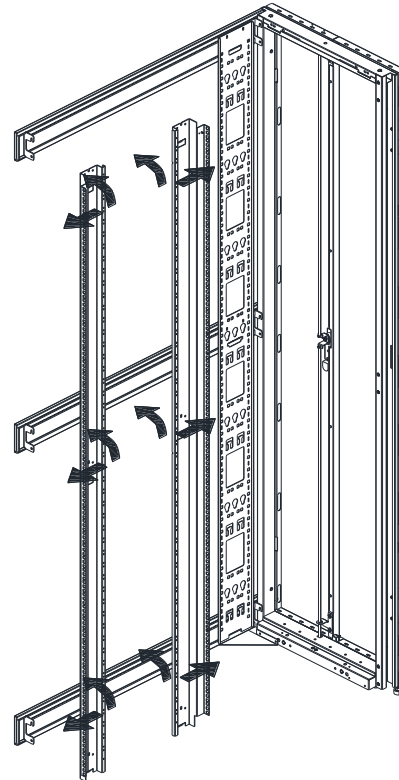

- The mounting rails of the 800mm width rack is divided into the front and rear.

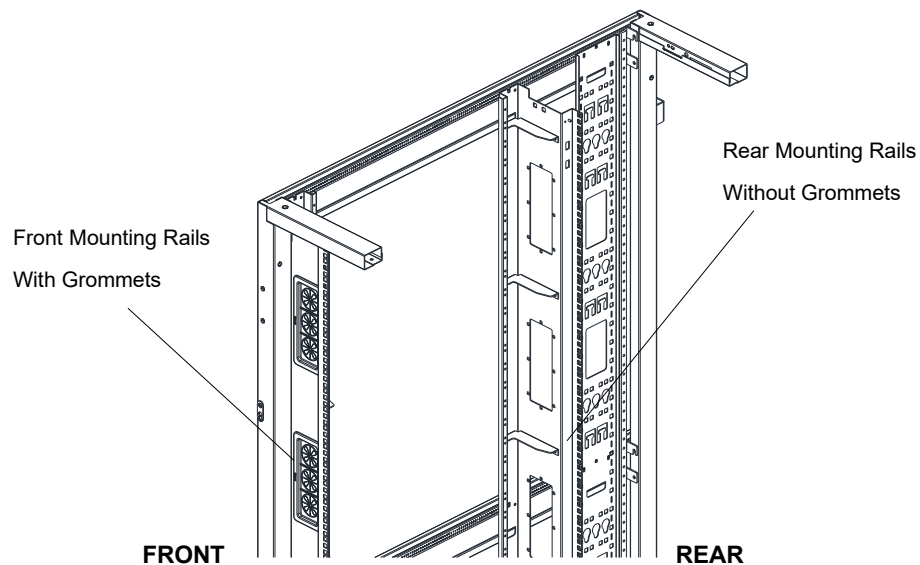

## AIR DAM KIT

If the selected cabinet is supplied without rear doors, the air dam kit must be installed as a primary component.

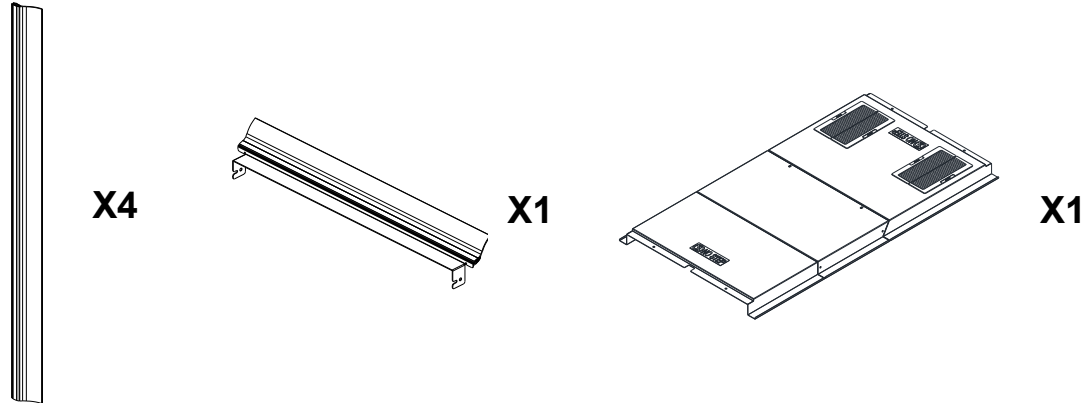

- Clip the air sealing gaskets to the front mounting rails.
- Secure the top U gasket by Philips pan head self-tapping screws (M4X8).
- Follow the three steps (3, 4 and 5) below to install the bottom panel.

**Note:** Please refer to Figures 1 and 2 to verify the correct position and orientation of these gaskets.

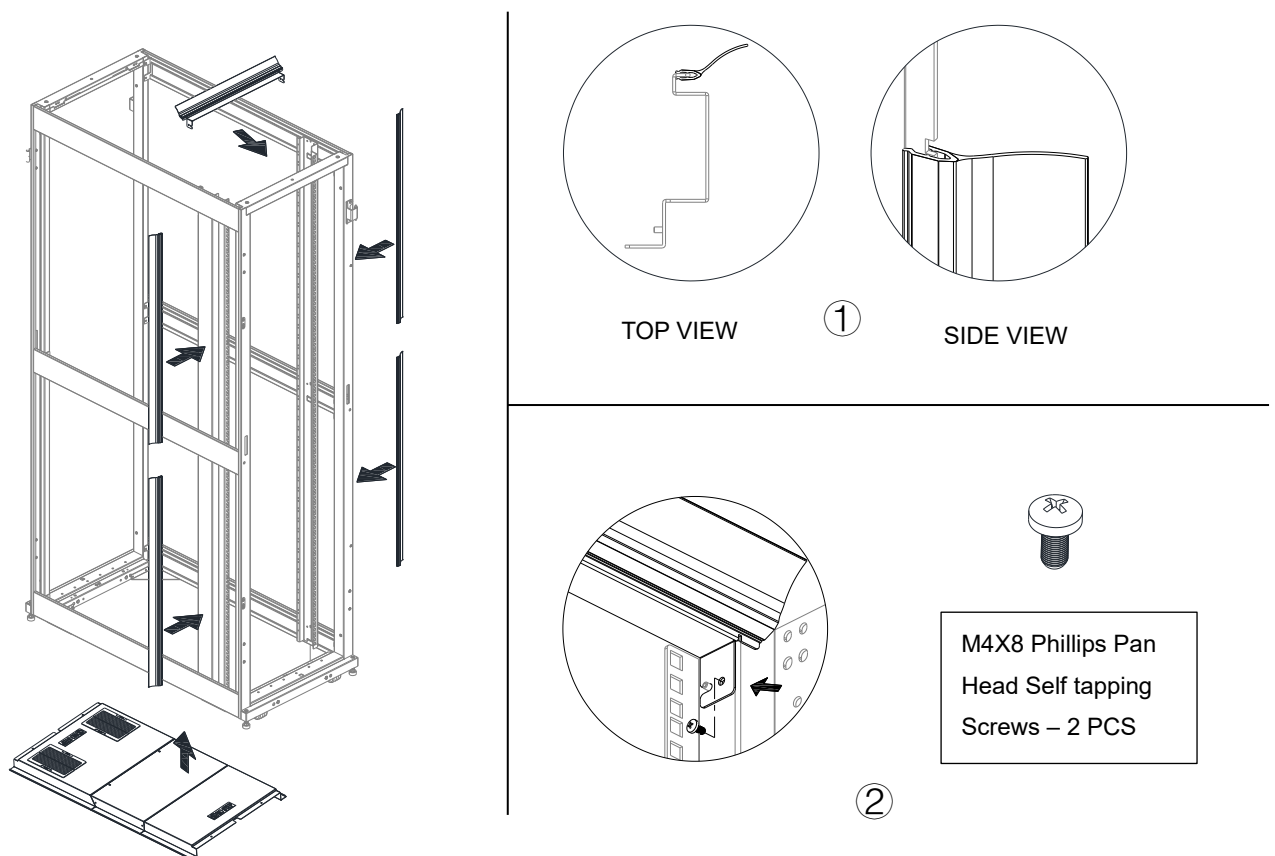

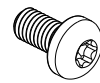
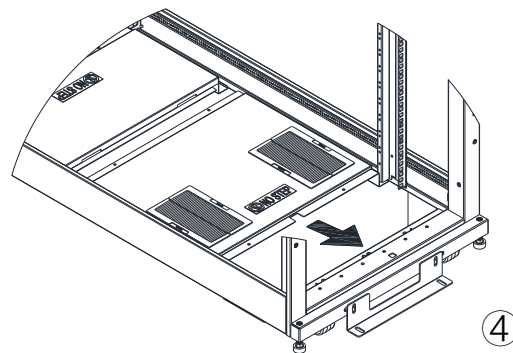
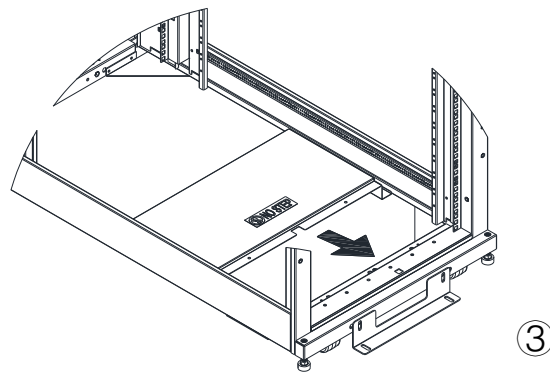

M5X10 Pan Head Torx Self  
Tapping Screws – 6 PCS

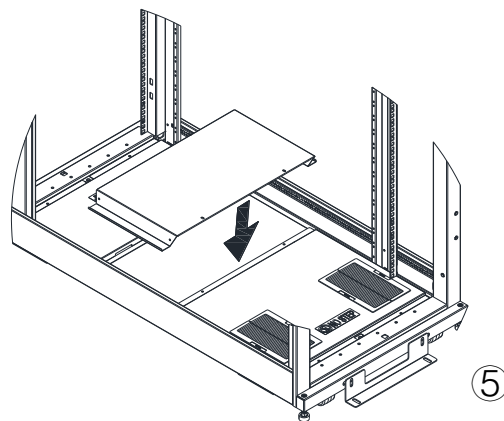



### **Top Panel**

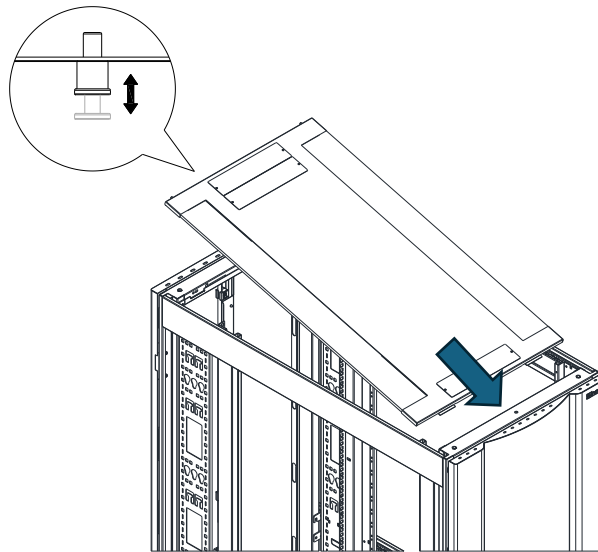

### **Side Panel**

- Slide the latch down and install the 4 side panels onto the frame.

